

TR

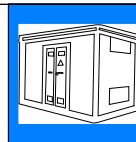
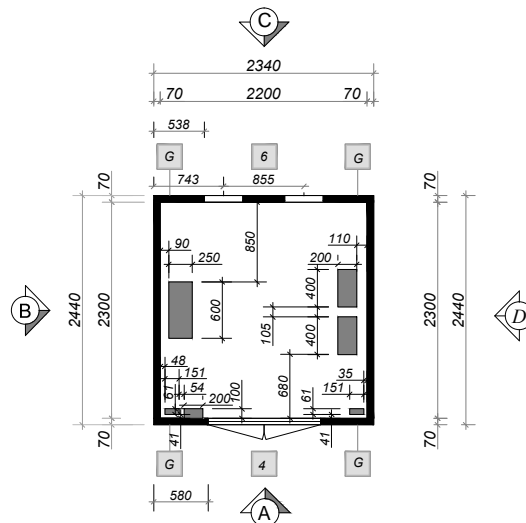

Architectural floor plan of a rectangular room. The overall dimensions are 2440 (width) by 2300 (depth). The room features a central area labeled "VANO TR" (entrance hall) at the bottom, flanked by two small rectangular elements. The left wall contains a "PER CANI MT" (cable management) unit. The right wall contains a "PER CANI RI" (cable management) unit and a "POTENZA" (power) unit. The plan includes four corner units labeled "G" and a central unit labeled "6". Dimensions are marked with arrows: 2440 and 2300 for the overall size, and 70 for the offset from the walls to the corner units. A central unit "4" is located below the entrance hall. A compass rose indicates North (N) is towards the top-left.

**CONFERMA D' ORDINE:**

PROGETTO PIANTE-PROSPETTI		TAV. <div style="border: 2px solid black; border-radius: 50%; width: 60px; height: 60px; display: flex; align-items: center; justify-content: center; margin: 0 auto;"> 1/1 </div>		SCALA -----	
REVISIONE N. <div style="font-size: 2em; font-weight: bold; text-align: center;">00</div>		PESO STRUTTURA Q.t.		PEZZI	
		CL.S.		ACCIAIO	
		Rck 400		RETE ELETTR.	
				Fe b 44 K / 32 K	
				Fe b 44 K	

REDAZIONE GRAFICO		PROGETTISTA		DATA	
ARCH. R. MORIELLO		ELETTRODI		ESAB OK 4339/3,2	
		RESIST. SFORMO		140 Kg/cmq	
CONTROLLO GRAFICO		BOCCOLE		GOLFARI	
ING. E. D'ANDRIA		MA 08 <input type="checkbox"/>		<input checked="" type="checkbox"/> 16 <input type="checkbox"/>	
		MA 12 <input checked="" type="checkbox"/>		<input checked="" type="checkbox"/> 18 <input type="checkbox"/>	
		MA ... <input type="checkbox"/>		<input checked="" type="checkbox"/> 30 <input checked="" type="checkbox"/>	
				TOLLERANZE Strutture Monodir.Solai e Pannelli L = ± 25 mm. L = ± 20 mm. s = ± 10 mm. s = ± 10 mm.	

1	PORTA A DUE ANTE IN VTR (mm 1200x2150)
2	PORTA AD UN'ANTA IN VTR (mm 600x2150)
3	GRIGLIA ALTA IN VTR (mm 1200x500)
4	GRIGLIA BASSA IN VTR (mm 1200x500)

- | | |
|---|-------------------------|
| a | MODULI MT ENEL |
| b | CONTATORE ENEL |
| c | MODULI MT UTENTE |
| F | VASCA DI FONDAZIONE |
| G | GOLFARI DI SOLLEVAMENTO |

 *FORI A PAVIMENTO*
 *COPERTURE*

	COLORE FRONTE COPERTURA : GIALLO OCRA-RAL 1024
	COLORE ESTERNO : GIALLO OCRA-RAL 1024
	COLORE VASCA DI FONDAZIONE: GRIGIO CEMENTO
	RIFINITURA ESTERNA : GRAFFIATO

Timbro e firma per accettazione